

**Preliminary Assessment  
And  
Certification of Compliance  
of an  
Identified Illegal Drug Laboratory  
at:  
262 Homestead Circle  
Bayfield, CO 81122**

**Prepared for:**

Peter D. Rowland  
PO Box 257  
Durango, CO

Prepared by:

**FORENSIC APPLICATIONS CONSULTING TECHNOLOGIES, INC.**  
185 Bounty Hunter's Lane  
Bailey, CO 80421



May 11, 2015

## TABLE OF CONTENTS

EXECUTIVE SUMMARY .....	4
Subject Structure .....	4
Attic .....	4
Crawlspace .....	4
Personal Belongings .....	4
Major Appliances .....	4
General Structural Layout .....	5
REGULATORY REQUIREMENTS .....	6
County Requirements .....	6
State Requirements .....	7
Preliminary Assessment .....	7
Elements of the Preliminary Assessment .....	7
Initial Statement on Testing .....	10
Review of Law Enforcement Documentation .....	10
Governing Body .....	10
Visual Inspection of the Property .....	10
EXTERIOR GROUNDS .....	11
SEWERAGE SYSTEM .....	11
IDENTIFICATION OF COOK/STORAGE AREAS .....	11
IDENTIFICATION OF USE AREAS .....	11
CONTAMINATION MIGRATION .....	11
Furnace System Considerations .....	12
SAMPLE COLLECTION .....	12
Wipe Samples .....	12
Methamphetamine Analysis .....	13
Sample Results .....	13
Sample Locations .....	14
Regulatory Sample Results .....	16
Description of Sampling Procedures .....	17
QA/QC Precautions .....	22
Field Blanks .....	22
Bias .....	23
Cross Contamination .....	23
REGULATORY CERTIFICATION .....	23
CONCLUSIONS .....	25

Appendix A: Supporting Documents

- Property Description
- Law Enforcement Documentation
- Inventory of Chemicals
- Photolog
- Structural Features Description
- Room Inventory
- Plumbing Inspection and Appliance Inventory
- Ventilation Inspection and Inventory
- Field Observations
- Individual Sewage Disposal System Field Form
- Signature Sheet
- Statement of Qualifications

Appendix B: Analytical Reports for FACTs Samples

- Field sheets
- Laboratory Analysis reports



Appendix C: Compact Digital Disk  
Photographs  
Regulations  
Methods



## EXECUTIVE SUMMARY

The Registered Owner of 262 Homestead Circle, Bayfield, CO 81122 (the subject property), in conjunction with the occupant, became concerned that the actions of a former occupant may have resulted in methamphetamine contamination at the subject property. The Registered Owner performed a qualitative test for the presence of methamphetamine and determined the presence of methamphetamine at a concentration of at least 0.1 micrograms per 100 cm<sup>2</sup>.

On April 23, 2015, at the request of the Registered Owner, personnel from Forensic Applications Consulting Technologies, Inc. (FACTs) began the process of performing a Preliminary Assessment of the subject property pursuant to Colorado Regulations 6 CCR 1014-3 “*Regulations Pertaining To The Cleanup Of Methamphetamine-Affected Properties* (Amended 2014).”

During the Preliminary Assessment, FACTs collected samples pursuant to Section 6 of the regulation, and based on those samples and the totality of circumstances, FACTs issues this “Certificate of Compliance” for the residence located at 262 Homestead Circle, Bayfield, CO 81122 pursuant to CRS 25-18.5-101 *et seq* and 6 CCR 1014-3.

This Preliminary Assessment (PA) was performed by Mr. Caoimhín P. Connell, Forensic Industrial Hygienist with Forensic Applications Consulting Technologies, Inc (FACTs).

### **Subject Structure**

The *circa* 2003 single family, single story, structure approximates 2,164 square feet (including the garage, excluding the crawlspace). The property is a dug-out, poured concrete wall foundation resulting in an earthen crawlspace housing the furnace system. The sewerage system is city sewerage.

### **Attic**

There is no attic, and there is no access to the ceiling wall cavity.

### **Crawlspace**

The isolated crawlspace is in excellent condition and is not covered by a vapor barrier.

### **Personal Belongings**

During our assessment, the property was unoccupied. The current tenants had evacuated the property leaving all personal belongings in the residence. Pursuant to regulations, all personal items can be released to the owner since, based on the totality of circumstances, we have determined (pursuant to §5.11.1.4.1), that those items are not contaminated.

### **Major Appliances**

During our assessment, the residence contained:

A Microwave



- A stove/oven
- A dishwasher
- A chest freezer
- A refrigerator
- A clothes washer
- A clothes dryer

### General Structural Layout

A general aerial layout of the residential setting is depicted in the photograph below; the subject property, including curtilage, is approximated by the yellow outline

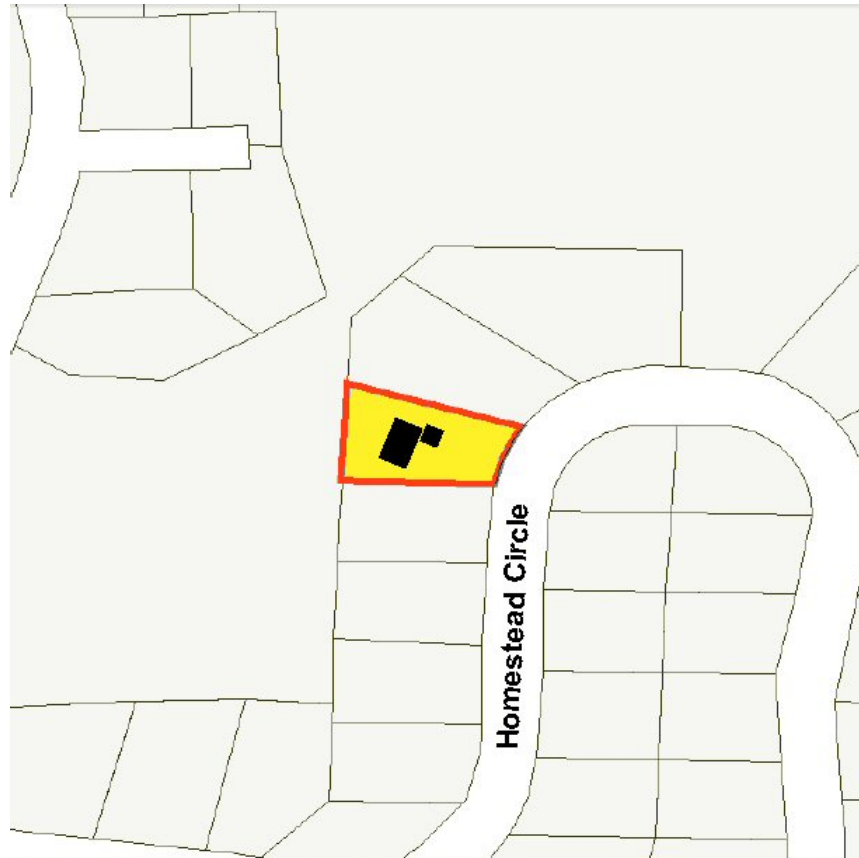


**Figure 1  
General Site Layout<sup>1</sup>**

The figure below identifies a partial plat for the area with the subject property in red.

<sup>1</sup>Possible Copyright by Google; fair use exemption accessed through Google Earth™





**Figure 2**  
**General Site Layout<sup>2</sup>**

The subject property is part of a new development surrounded by similar single family residences. The structure has a detached two-car garage.

The kitchen range, clothes dryer, forced air flue stack from the main floor, as well as two bathroom exhaust vents penetrates the ceiling to the roof. The structure contains a full contingent of major appliances. All major appliances were sampled. At the time of our assessment, the residence was furnished in a normal manner.

## **REGULATORY REQUIREMENTS**

### ***County Requirements***

Based on the best information available, there are no local regulations for this jurisdiction.

---

<sup>2</sup> La Plata County Assessor Office



## State Requirements

For this project, the Preliminary Assessment has been performed pursuant to Colorado Regulations 6 CCR 1014-3 as well as Colorado Revised Statutes Title 28, Article 18.5, Part 101 *et seq.*

## Preliminary Assessment

According to Colorado State Regulation 6-CCR 1014-3, following the discovery of an illegal drug laboratory, as that term is defined in CRS §25-18.5-101, and following “notice,” the property must be subjected to one of four actions:

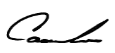
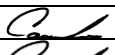
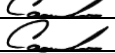

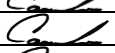
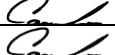



- The property may be sold, and the new owner has 90 days to bring the property into compliance;
- The property owner may elect to have a “full clearance sampling protocol as specified in Section 6;”
- The property owner may elect to have a Preliminary Assessment performed;
- The property owner may elect to demolish the property.

Pursuant to the regulations, information obtained in the PA, and those findings, enter the public domain and are not subject to confidentiality.<sup>3</sup>

The PA must be conducted according to specified requirements<sup>4</sup> by an authorized Consultant as that term is defined in CRS §24-30-1402. This document, and all associated appendices and photographs, is the PA pursuant to those regulations. Included with this discussion is a read-only digital disc. The disc contains mandatory information and photographs required by State regulation for a PA.

## Elements of the Preliminary Assessment

Specific mandatory information must be presented as part of the PA. This discussion, in its totality, contains the mandatory information for a PA as follows:

Rubric	Requirement	Present
§4.1	Physical address, legal description, number and type of structures present, adjacent and/or surrounding properties.	
§4.2	Law enforcement review discussion included	
§4.3	Description of structural features in all buildings	
§4.3.1	Description of attic(s)	
§4.3.1	Description of bathroom and kitchen exhaust ducting	
§4.3.2	A description of the building floor	
§4.3.2	A description of the crawl space	
§4.3.2	A description of the crawl space vapor barrier	
§4.4	Description of outdoor areas	

<sup>3</sup> Section 4.20, Part 1, 6 CCR 1014-3

<sup>4</sup> Section 4 of 6 CCR 1014-3



§4.4.1	Factors limiting the inspection	<i>[Signature]</i>
§4.5	Identification of manufacturing methods	<i>[Signature]</i>
§4.6	Identification of chemicals used	<i>[Signature]</i>
§4.7	Identification and documentation of areas of contamination.	<i>[Signature]</i>
<b>For single-family dwellings, have the following been addressed:</b>		
§4.7	All rooms	<i>[Signature]</i>
§4.7	Attics	<i>[Signature]</i>
§4.7	Crawl spaces	<i>[Signature]</i>
§4.7	Forced air ventilation systems	<i>[Signature]</i>
§4.7	Exhaust fans	<i>[Signature]</i>
§4.8	Identification of chemical storage areas	<i>[Signature]</i>
§4.8	Identification of waste disposal areas	<i>[Signature]</i>
§4.8	Identification of cooking areas	<i>[Signature]</i>
§4.8	Identification of use areas	<i>[Signature]</i>
§4.9	Identification of signs staining, etching, or fire damage.	<i>[Signature]</i>
§4.10	Description of plumbing system	<i>[Signature]</i>
§4.10	Description of OWTS field screening	NA
§4.13	Identification of surfaces known or suspected to have been painted or sealed after cessation of contamination-causing activities.	<i>[Signature]</i>
§4.14	Photographic documentation of property conditions.	<i>[Signature]</i>
§4.15.1/§4.17.1	Description of the sampling procedures used.	<i>[Signature]</i>
§4.15.1/§4.17.2	Description of QA/QC	<i>[Signature]</i>
§4.15.2/§4.17.2	Documentation of the analytical methods used	<i>[Signature]</i>
§4.15.2/§4.17.2	Documentation of laboratory QA/QC requirements	<i>[Signature]</i>
§4.15.2/§4.17.2	Documentation of chain-of-custody	<i>[Signature]</i>
§4.15.3	Laboratory results of sampling	<i>[Signature]</i>
§4.15.3	Description of sample locations	<i>[Signature]</i>
§4.15.3	Computer generated figure illustrating the layout of the building(s)	<i>[Signature]</i>
§4.15.3	Computer generated figure illustrating sample locations	<i>[Signature]</i>
§4.16	Documentation of personal property assessment	<i>[Signature]</i>
§4.17.4	Documentation of variations from standard practices.	<i>[Signature]</i>
§4.19	Preliminary Assessment certification statement	<i>[Signature]</i>
§4.20/§8.10	Preliminary Assessment Report sent to the Governing Body	5/11/15
§4.20	Preliminary Assessment Report sent to the Department	6/10/15

**Table 1  
Mandatory Elements of a Preliminary Assessment**

**General Sampling Requirements**

Rubric	Action	Status
§6.2.11	Have all sample locations been photographed?	<i>[Signature]</i>
§6.9	Have all structures on the property been sampled?	<i>[Signature]</i>
§6.9.1	Collected at least 400 cm <sup>2</sup> from every "room?"	<i>[Signature]</i>
§6.9.1	Collected at least 400 cm <sup>2</sup> from every attic?	NA
§6.9.1	Collected at least 400 cm <sup>2</sup> from every crawlspace?	<i>[Signature]</i>
§6.9.2	Has at least 800 cm <sup>2</sup> of total surface been sampled from the property	<i>[Signature]</i>
§6.9.3	Has an additional 100 cm <sup>2</sup> of surface area been sampled for each additional 500 ft <sup>2</sup> greater than (or fraction thereof) 500 ft <sup>2</sup> ? (Specify below)	<i>[Signature]</i>
Room: Living Room Complex	Square feet: 810	<i>[Signature]</i>





### General Sampling Requirements (continued)

§6.9.4	Has 100 cm2 of the heat exchanger unit been sampled?	<i>Cal</i>
	Has 100 cm2 of the cold air return system been sampled?	
	Has 100 cm2 of the supply air system been sampled?	
	Has 100 cm2 of a fourth elective been sampled?	
§6.9.4	Photo documentation to verify that the ventilation system has been cleaned and is free of debris?	NA
§6.9.5	Has one discrete sample been collected from each non-ducted heating, cooling or circulating unit?	NA
§6.9.7	Has the interior of all major appliances (microwaves, refrigerators, freezers, ovens, and dryers) been sampled?	<i>Cal</i>

#### Multi-unit building

Rubric	Action	Status
§6.9	If there is exclusive access to any auxiliary portion of the multi-unit property (such as a storage room or garage): Have all such auxiliary structures been sampled?	NA

### Elements of Final Postdecontamination Report

Rubric	Inclusion	Status
§4.11.1	Have the limitations on access of a contaminated shared attic in a multi-unit structure been documented?	NA
§4.11.1	Does the final report contain language about contacting the HOA regarding contaminated shared attic in a multi-unit structure?	NA
§4.11.2	Have the limitations on access of a contaminated shared crawlspace in a multi-unit structure been documented?	NA
§4.11.2	Does the final report contain language about contacting the HOA regarding contaminated shared crawlspace in a multi-unit structure?	NA
§4.12	Have the limitations on access of a contaminated shared ventilation system in a multi-unit structure been documented?	NA
§4.12	Does the final report contain language about contacting the HOA regarding contaminated shared ventilation system in a multi-unit structure?	NA
§8.1	Does the final report contain a summary of the Preliminary Assessment Report or a copy thereof?	<i>Cal</i>
§8.2	Photographic documentation of post-decontamination property conditions.	NA
§8.2	Photographic documentation previously identified cooking areas, chemical storage areas, waste disposal areas, areas of obvious contamination and sample locations.	NA
§8.3	A description of the sampling procedures used, including sample collection, handling, and QA/QC.	<i>Cal</i>
§8.4	Documentation of the analytical methods used, laboratory QA/QC documentation, laboratory report and chain-of-custody.	<i>Cal</i>
§8.5	Results of post-decontamination clearance sampling	NA
§8.5	Computer generated figure of post-decontamination clearance sampling	NA
§8.6	Date FACTs received Contractor's "Decontamination Summary Report"	NA
§8.7	Evidence of Consultant certification	<i>Cal</i>
§8.8	Signed mandatory language of certification	<i>Cal</i>
§8.9	Date copy provided to the property owner	5/11/15
§8.9	Date copy provided to the Contractor(on or before)	NA
§8.9	Date copy provided to the Department (on or before)	6/10/15
§8.10	Date copy provided to the Governing Body (on or before)	5/11/15

**Table 2**  
**Elements of a Final Report**



## **Initial Statement on Testing**

Contrary to common belief and contrary to false statements<sup>5</sup> made by individuals with the CDPHE, sampling is **not** required during a PA. However, for this property, regulatory sampling was performed to challenge specific areas if needed.

Ultimately, all areas were challenged, all samples were analyzed, and all areas were demonstrated to be compliant.

## **Review of Law Enforcement Documentation**

As part of the PA, FACTs is required by regulation<sup>6</sup> to review available law enforcement documents pertinent to a subject property. For this jurisdiction, the La Plata County Sheriff's Office and the Bayfield Marshall's Office both exhibited the highest degree of professionalism and courtesy, and promptly responded to our requests for information.

The Bayfield Marshall's Office informed us the residence is not within the Town Limits of Bayfield.

The La Plata County Sheriff's Office informed us they did not have any documentation pertinent to controlled substances for the residence.

## **Governing Body**

The property lies within La Plata County, and pursuant to CRS §25-18.5-101(7), according to the San Juan Basin Health Department, the office of the "Governing Body" is:

La Plata County Sheriff's Office  
742 Turner Dr.  
Durango, CO 81303

## **Visual Inspection of the Property**

On April 24, 2015, FACTs' Industrial Hygienist visited the subject property and performed a visual inspection of that property. During this inspection, pursuant to regulatory requirements, each structural feature in the property was identified and an indicia inventory and assessment was performed for each area. The results of those inspections are found in FACTs Field Forms which accompany this report.

---

<sup>5</sup> Letter from Colleen Brisnehan, to Joan Whittemore (CSPD) and Sgt. Harrell (CSPD) regarding Citizen Request #4967 (Tuesday, September 4, 2012 4:00 pm) From: [WHITTEJO@ci.colospgs.co.us](mailto:WHITTEJO@ci.colospgs.co.us) to FACTs, Inc.

<sup>6</sup> 6 CCR 1014-3 (Section 4.2)



In general, we found no indicators consistent with controlled substance use, or otherwise processing methamphetamine.

## **EXTERIOR GROUNDS**

On the day of our visit, the exterior grounds were readily accessible but in the winter vegetative state. Historical aerial photography for the immediate vicinity provided various indications of stressed vegetation; however, none of the stressed vegetation was consistent with dumping of illegal wastes at the property.

## **SEWERAGE SYSTEM**

Regulation 6-CCR-1014-3 (§4.10) requires inspection of plumbing system integrity and identification and documentation of potential disposal into the sanitary sewer or an on-site wastewater treatment system (OWTS). For this property, there is no OWTS, and there were no indications that inappropriate wastes had been discarded into any portion of the plumbing system.

Normally, FACTs measured the organic vapor concentrations in the P-traps of the plumbing system with a photoionization detector. For this property, however, there were insufficient indicators to suggest illegal discharge, and VOC readings were not taken.

## **IDENTIFICATION OF COOK/STORAGE AREAS**

Colorado Regulations 6 CCR 1014-3 (4.8) states that the Consultant is required to perform:

*Identification and documentation of chemical storage areas, waste disposal areas, cooking areas, and/or use areas, if known.*

Based on the best information available, we were unable to identify any indicators of waste storage or disposal within the context of the regulations. It is our best assessment that at some time in the past, a former occupant of the residence smoked methamphetamine in the structure.

## **IDENTIFICATION OF USE AREAS**

Based on the best information available, use (smoking) probably occurred in the living room kitchen area.

## **CONTAMINATION MIGRATION**

There were no indications that fugitive emissions would have occurred from the subject property. We were not otherwise able to find any indicators that would suggest migration of contamination off site.



## ***Furnace System Considerations***

The Furnace System in the structure is a standard residential forced air system. The actual mechanical unit is located in the laundry room with a ducted distribution system throughout the entire residential structure.

## **SAMPLE COLLECTION**

According to the new regulations,<sup>7</sup> there is no objective to sampling. That is, in the amended regulations, the State of Colorado removed the rationale for the collection of samples and therefore no data quality objectives are to be met. The Colorado Department of Public Health and Environment rejected scientifically valid data quality objectives (DQOs) that are the backbone of all environmental sampling. The Colorado Department of Public Health and Environment removed the sampling provisions from the regulations stating that the provisions were too difficult to be understood by untrained consultants who were otherwise performing unlawful assessments.

As such, in Colorado, according to the new regulations, a consultant is permitted to knowingly collect samples from inappropriate locations, knowing those locations would indicate compliance for an otherwise heavily contaminated, noncompliant property.

For this project, FACTs nevertheless employed valid sampling rationale, and identified the *a priori* hypothesis:

*The surfaces contained methamphetamine levels in excess of regulatory thresholds.*

Those regulatory thresholds were 0.5µg/100cm<sup>2</sup> for general surfaces in the occupiable portions of the residence and 4 µg/100cm<sup>2</sup> for the crawlspace. Then, employing authoritative judgment bias sampling, FACTs diligently attempted to support the hypothesis.

The hypothesis was not supported and therefore, FACTs accepts the null hypothesis for all areas challenged:

*The residential surfaces do not contain methamphetamine levels in excess of regulatory thresholds.*

## ***Wipe Samples***

The wipe sample medium was 2 inch by 2 inch commercially available cotton-poly mixed wipes impregnated with USP isopropyl alcohol. Each proposed sample area was delineated with a measured outline, in compliance with §6.2.2. Samples were collected from surfaces exactly as described in §6.2.4 through §6.2.10. Following the collection of each sample, the gauze material was returned to its independent centrifuge tube and capped with a screw-cap.

---

<sup>7</sup> 6 CCR 1014-3, Amended



## ***Methamphetamine Analysis***

The wipe samples were submitted under the special regulatory chain-of-custody for analysis to Reservoirs Environmental Laboratories in Denver, CO for analysis by GCMS.<sup>8</sup> The special regulatory chain-of-custody form is not a normal chain of custody but rather contains additional regulatory requirements found in Sections §6.2.14.1 through §6.2.14.12

## ***Sample Results***

In the following table, we have presented the sampling performed in association with demonstrating the attainment of State clearance levels. The verification data is expressed in units germane for comparison against regulatory State levels. All results are in µg/100cm<sup>2</sup> unless otherwise indicated. State regulations no longer permit an Industrial Hygiene interpretation of the data, and none is presented.

Sample ID	Sample Location	Area cm <sup>2</sup>	Results
HM042415-01A	Furnace cold air return	100	<0.01
HM042415-01B	Furnace heat exchanger	100	
HM042415-01C	Furnace supply air	100	
HM042415-01D	Furnace cold air return	100	
HM042415-02	SE Bedroom closet door	400	0.01
HM042415-03	SE Bedroom closet door frame	400	0.02
HM042415-04	Common bathroom exhaust fan	400	0.11
HM042415-05	Laundry room top of cabinet	400	0.15
HM042415-06	Clothes washer	100	<0.05
HM042415-07	Clothes dryer	100	<0.05
HM042415-08	Freezer inside lip	100	0.05
HM042415-09	Living Room Complex -Kitchen top of cabinets	400	0.20
HM042415-10	Living Room Complex - top of light fixture in dining room	100	0.06
HM042415-11	Field Blank	NA	<0.05*
HM042415-12	Refrigerator shelf	100	<0.05
HM042415-13	Microwave inside door	100	<0.05
HM042415-14	Dishwasher interior	100	<0.05
HM042415-15	Stove inside door	100	<0.05
HM042415-16	Master bedroom door frame to bath	400	0.03
HM042415-17	Master bathroom top of light fixture	400	<0.01
HM042415-18	Garage door rail	400	0.02
HM042415-19	Crawlspace steel beam	400	<0.01
HM042415-20	Field Blank	NA	<0.05*

\* Absolute micrograms; "<" indicates "less than"

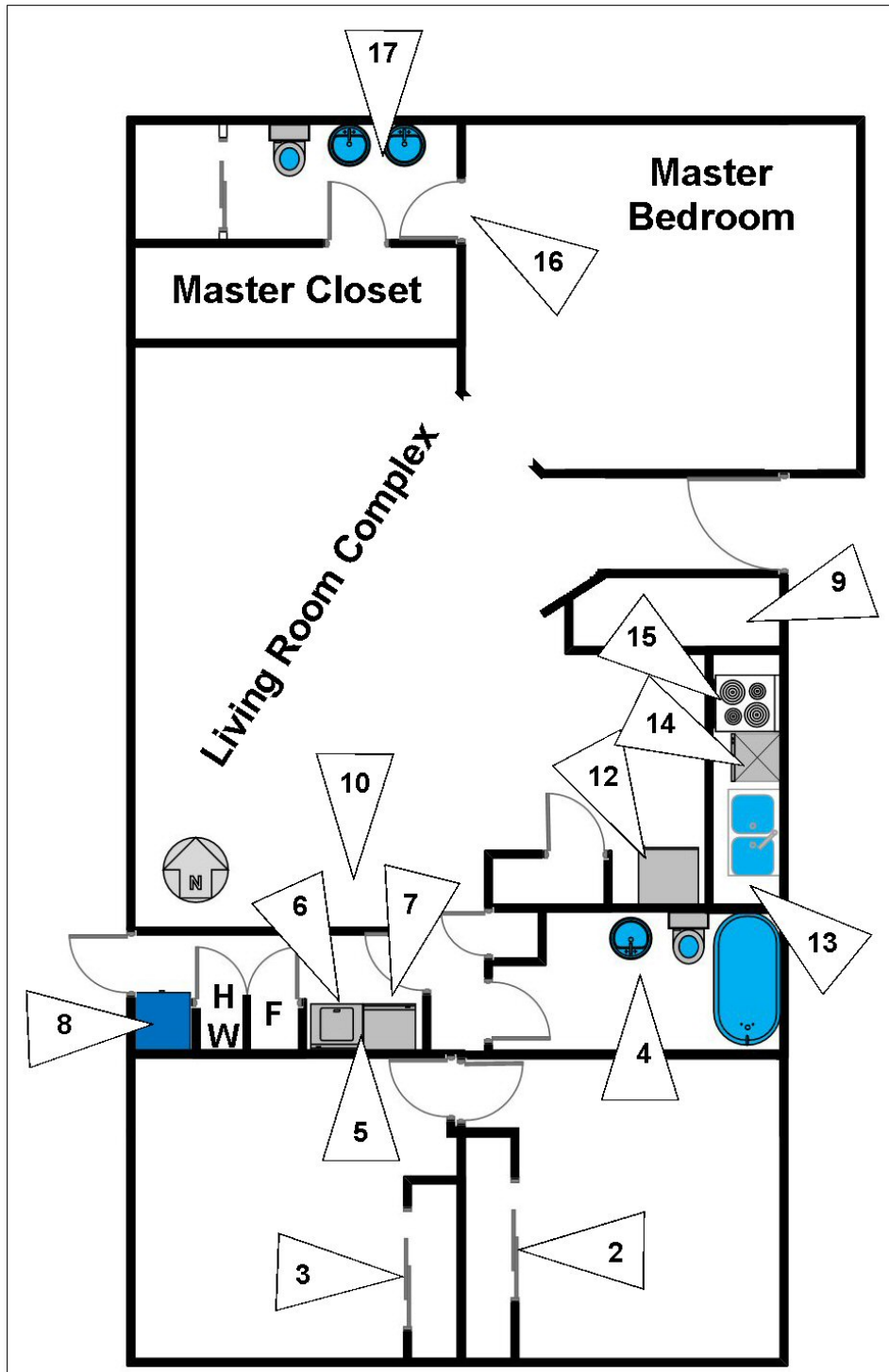
**Table 3**  
**Sample Results**

<sup>8</sup> The laboratory essentially uses the NIOSH Method 9106 "METHAMPHETAMINE and Illicit Drugs, Precursors and Adulterants on Wipes by Liquid-Liquid Extraction"



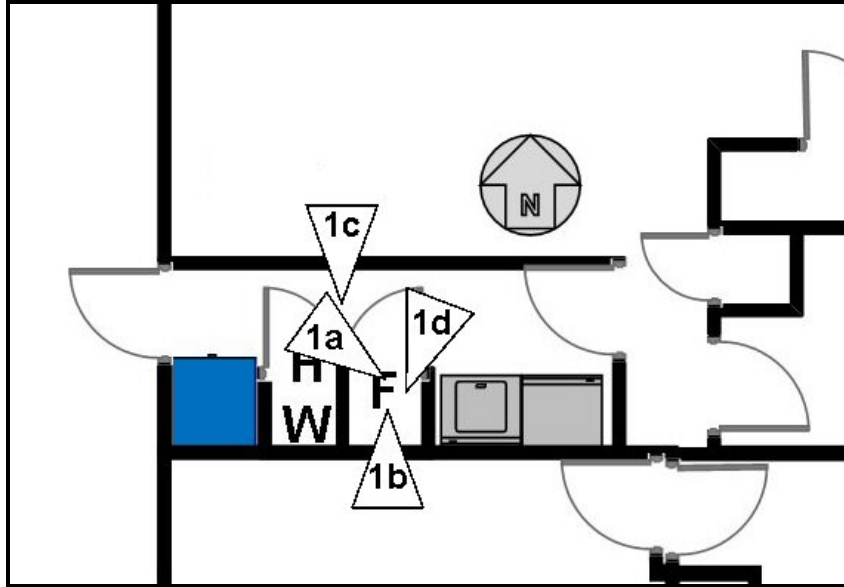
## Sample Locations

In the following drawings, FACTs has presented the sampling locations.

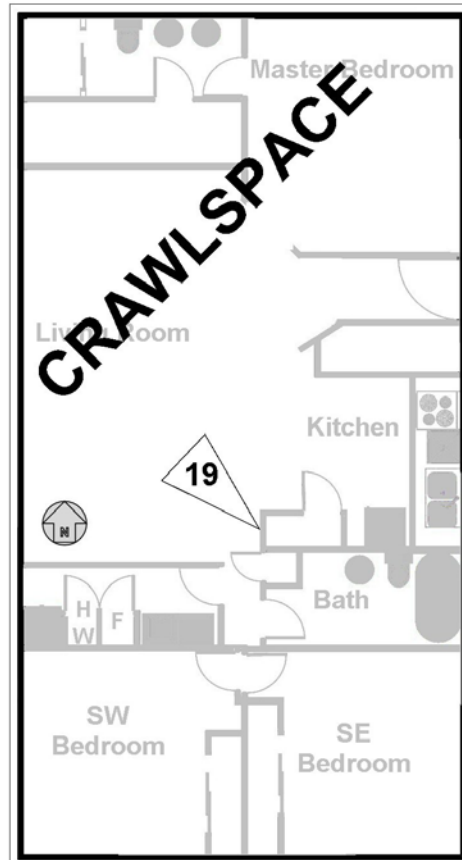


**Figure 3**  
**Main Floor Sample Locations**



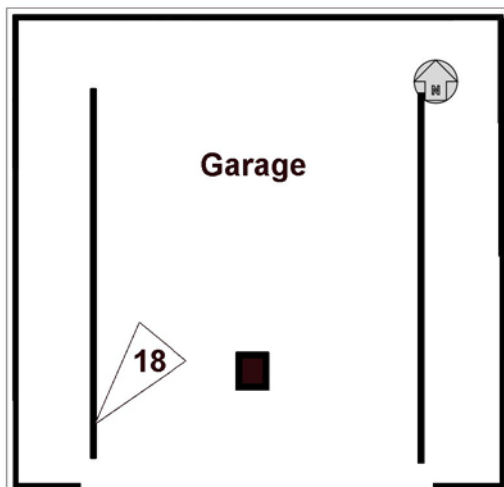


**Figure 4**  
**Sample Locations - Furnace Detail**



**Figure 5**  
**Crawlspace Sample Location**





**Figure 6**  
**Garage Sample Location**

### **Regulatory Sample Results**

The new state regulations were so badly written, even the word “methamphetamine” was misspelled on official documents,<sup>9</sup> and the regulations are so badly administered that as of this morning (May 6, 2015), the Colorado Department of Public Health and Environment have the wrong regulations identified on their official website. One of the many requirements of the regulations (§4.15.3 and §4.17.3 and also §8.5) is that “*Sample results shall be presented as reported by the analytical laboratory, and shall not be adjusted, changed, or manipulated in any way.*” Therefore, for the purposes of meeting those requirements, the following figure is presented:

---

<sup>9</sup> See for example, [http://www.forensic-applications.com/meth/CDPHE\\_Meth\\_Blank.pdf](http://www.forensic-applications.com/meth/CDPHE_Meth_Blank.pdf)





Client ID Number	Lab ID Number	Reporting Limit (µg)	METHAMPHETAMINE CONCENTRATION (µg)
HM042515-01	EM 1393722	0.05	BRL
HM042515-02	EM 1393723	0.05	0.05
HM042515-03	EM 1393724	0.05	0.07
HM042515-04	EM 1393725	0.05	0.45
HM042515-05	EM 1393726	0.05	0.60
HM042515-06	EM 1393727	0.05	BRL
HM042515-07	EM 1393728	0.05	BRL
HM042515-08	EM 1393729	0.05	0.05
HM042515-09	EM 1393730	0.05	0.81
HM042515-10	EM 1393731	0.05	0.06
HM042515-11	EM 1393732	0.05	BRL
HM042515-12	EM 1393733	0.05	BRL
HM042515-13	EM 1393734	0.05	BRL
HM042515-14	EM 1393735	0.05	BRL
HM042515-15	EM 1393736	0.05	BRL
HM042515-16	EM 1393737	0.05	0.12
HM042515-17	EM 1393738	0.05	BRL
HM042515-18	EM 1393739	0.05	0.09
HM042515-19	EM 1393740	0.05	BRL
HM042515-20	EM 1393741	0.05	BRL

**Figure 7**  
**Sample Results Pursuant to Sections §4.15.3 and §4.17.3 and §8.5**

Obviously, however, if the data were presented only as required, one would not know from whence came the sample or the final concentration of that sample for comparison with regulatory levels. Therefore, at *some* point the sample results **must** be adjusted, changed or manipulated in some manner by *someone*; (data don't just calculate themselves). Those data are found in the FACTs summary table earlier in this discussion.

***Description of Sampling Procedures***

According to the regulations, this report must contain:

*4.15.1 A description of the sampling procedures used, including sample collection, handling, and QA/QC.*

Therefore, the following discussion is presented in compliance with that mandatory requirement.

The new regulations incorporate unfounded wiping protocols that were invented with disregard for actual environmental sampling considerations. In most cases, it is physically impossible to actually comply with the new sampling protocols and collect a legitimate sample at the same time.



For example, imagine a consultant determines the best (or indeed the only) suitable surface in a room to be cleared is an ornate surface, such as the hanging light fixture in the photograph below:



**Photograph 1  
Ornate Surface**

According to the new regulations, the consultant would not be permitted to sample the surface since the regulations require:

*6.2.7.1 Square method: Start at the outside edge and progress toward the center of the surface area by wiping in concentric squares of decreasing size.*

How does one determine the location of the “outside edge” of this item? Next, the consultant is required to

*6.2.7.2 “S” method: Wipe horizontally from side-to-side in an overlapping “S”-like pattern as necessary to completely cover the entire wipe area.*

How could one complete this mandatory maneuver? Next, the consultant is required to

*6.2.9 Use the same sample media to repeat the sampling of the same area using the same method. If using the “S” method, the second pass shall be sampled by wiping with overlapping “S”-like motions in a top-to-bottom direction.*



How could one complete this mandatory maneuver? Next, the consultant is required to:

*6.2.10 Fold sampled side in. Using the same sample media, sample the same area a third time. The third pass shall be sampled by wiping using the method not previously used (i.e., use the square method if the “S” method was originally used).*

Finally, the regulations *require*:

*6.1.3.1 Wipe **sampling shall be used** to determine the extent of methamphetamine contamination **on all surfaces** at all methamphetamine-affected properties, and at all properties that are undergoing a screening level assessment.*

Therefore, whereas the regulations would require the sampling on this item, the regulations simultaneously prevent the sample from being collected. On virtually every project one will encounter surfaces that are the best surface to sample, but which cannot be sampled according to the regulations (although the regulations simultaneously require such samples).

Thus, if the most suitable surface was an electrical cable that was 2 cm in circumference and 200 cm long, the Consultant could not collect a sample from that surface pursuant to the new rules, and yet, the surface may be the only suitable surface for that area.

Therefore, the consultant would have to turn a blind eye to an obviously dirty surface and find a different surface to demonstrate “compliance” knowing the disregarded surface may well be noncompliant.

It is a physical impossibility to use either a “Square method” or an “S method” to collect a sample from a surface with a convoluted topography, and yet, those surfaces are otherwise usually the best surfaces available to determine if a property has been properly cleaned.

Under the amended rules, the Consultant may be forced to collect a “regulatory sample” knowing that another suitable surface is contaminated, but from which one cannot collect a sample using the mandatory wiping protocols.

Similarly, the new regulatory cook-book sampling protocols (Square method/ S-method) effectively prohibit the collection of samples from narrow metal pipes, coaxial cables, radial fan blades, thin balusters, leading edge of a ceiling fan or a myriad of other suitable surfaces.

One cannot argue that the purpose of the regulation is to ensure that the sample method is designed to harvest the maximum amount of contamination. During the rulemaking process, without any scientific basis, the CDPHE decided to mandate the use of isopropyl alcohol to collect the sampling stating that methyl alcohol was a better collector of contaminant, and isopropyl was an inferior solvent, and therefore the consultant shall use the inferior solvent so that the surface does not yield all the methamphetamine present.



At the same time, the CDPHE mandated that the contact time on the surface be increased, and the number of passes be increased, thus increasing the salvation of paint artificially increasing the final results of the sample analysis. (No foundation or explanation was provided by the CDPHE in support of these provisions).

Similarly, Section 6 of 6 CCR 1014-3 disallows the collection of a 400 cm<sup>2</sup> sample, but requires the collection of four 100 cm<sup>2</sup> samples, per room (400 cm<sup>2</sup>). That is, the new regulations prohibit the Consultant from collecting a 400 cm<sup>2</sup> sample, but require the collection of 400 cm<sup>2</sup> which may be four 100 cm<sup>2</sup> samples combined into a single sample.

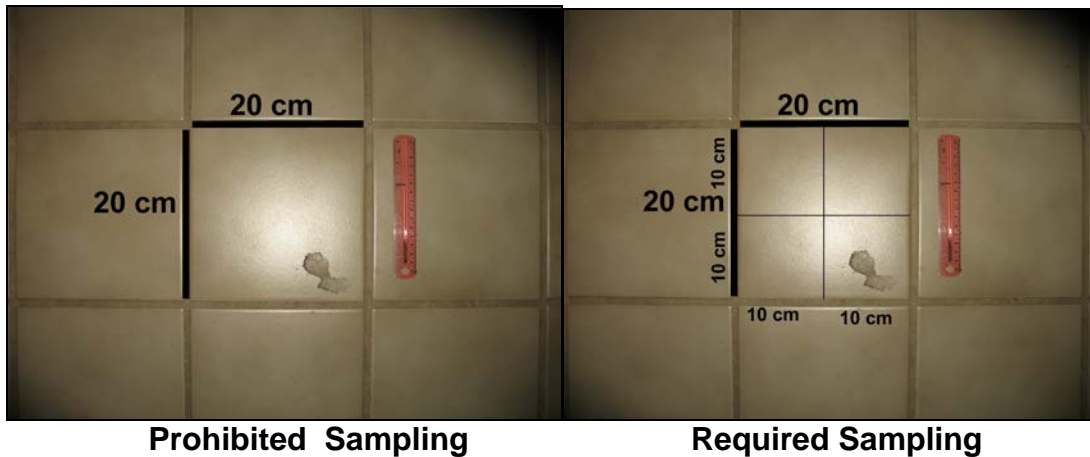
To illustrate, imagine the consultant wanted to collect a wipe sample from the 400 cm<sup>2</sup> ceramic wall tile depicted below:



**Photograph 2**  
**400 cm<sup>2</sup> Ceramic Wall Tile**

According to State Regulations the Consultant would be *prohibited* from collecting a sample from the tile by merely wiping the tile (as depicted in the Photograph on the left); but the consultant would required to collect four samples as depicted on the right, and combine all four samples into one analysis. The upshot is that the sample result will be exactly the same, of course, but one method is prohibited (left) and the other method is required (right).





Indeed, if the consultant wanted to just collect the sample from the wall tile, in the most intelligent manner (left), he would be **required** by regulations to prepare a written request to seek an official variance from the Department of Health which may take ten days to process, and the CDPHE has stated that the collection method on the left would

“... result in substantial deviation from the intent of the regulatory requirement.”<sup>10</sup>

However, the CDPHE never explains how collecting a single wipe from the tile versus four separate wipes from the tile and then combining all four wipes would “result in substantial deviation from the intent of the regulatory requirement” since obviously the two methods are identical and no rational support for the decision can be made.

Since the CDPHE removed the written intent of the regulations, it is no longer possible to know the intent of the regulatory sampling. As such, in Colorado, according to the new regulations, a consultant is permitted to knowingly identify a property as compliant by intentionally collecting samples from inappropriate locations, knowing those locations would indicate compliance for an otherwise heavily contaminated, noncompliant property.

As a result, cleaning contractors now know they do not have to actually decontaminate a house, *they only need to clean surfaces that can be sampled according to the regulations* – they can ignore all other contaminated surfaces in the structure.

The public no longer knows if the verification sampling actually verifies decontamination of their structure, rendering the home safe.

For this property, the sample locations were identified by the FACTs' Industrial Hygienist based on regulatory requirements. As such, since the sampling is designed to satisfy regulatory requirements, FACTs can guarantee the samples meet regulatory requirements

<sup>10</sup> Colleen Brisnehan, Hazardous Waste Corrective Action Unit, letter to FACTs February 27, 2015



but cannot guarantee the appropriateness or representativeness of the samples or their results, and the samples are interpreted exclusively within the context of the regulations.

### **QA/QC Precautions**

According to the new regulations (§4.15.1/§4.17.2), FACTs is required to discuss the quality assurance- quality control (QA/QC) aspects of the project. The following discussions are meant to satisfy those requirements.

### **Field Blanks**

Field blanks were collected and submitted for analysis pursuant to the requirements of the regulations (which are contrary to good sampling practices). The utility of field blanks, collected pursuant to State regulations is no longer valid, unless the results are below detection limits.

Under normal established, standard sampling environmental protocols, there are various types of “blanks.” The purpose of the field blank is to determine if the sampling materials and the handling procedures contributed to the presence of any contaminant identified. According to the new State regulations (Section 6.2.12.1), however, the Consultant is *required* by regulations to open and expose the field blank in a potentially contaminated property, and literally wave the sampling materials around in the potentially contaminated air.

The regulations actually read:

*6.2.12.1 To collect a field blank, remove a wipe from the wrapper with a new glove, shake the wipe open, refold in the same manner as during the sampling procedure, and then insert the wipe into the sample container.*

(It is impossible to comply with the regulations since the State never actually explained the bit about the “wrapper” or how the “wrapper” even exists in the first place, or how the blank material became “wrapped.”)

Therefore, if contamination is identified in the field blank there is no way to know if the contamination in the blank was due to tainted sampling materials, or if the reported contamination was the result of contamination as a result of the blank being intentionally exposed to/coming into contact with contamination while being opened in a contaminated property and waving the sampling materials around in the potentially contaminated air.

In the past ten years, prior to the new December 2014 regulations, FACTs’ data base indicated 312 consecutive field blanks that were below the analytical detection limits for the analytical method used. Under the new rules, in just the first six weeks alone, using the new regulated method, FACTs already had two field blanks with reportable quantities of methamphetamine. Using the mandatory method of collecting field blanks makes it impossible to know if a positive mass reported in a field blank is the result of tainted



sampling materials or if the required method of collecting the blanks contaminated the sampling materials.

Similarly, pursuant to State regulations, the Industrial Hygienist is required to make the 11th sample a blank and every subsequent 10th sample and the last sample of the collection suite a field blank. Because of this, the ability to submit surreptitious blanks to check the laboratory's abilities is lost.

## **Bias**

Since the regulatory sampling protocol is not scientifically based, but is based on meeting arbitrary regulatory parameters, no statement regarding bias can be made. All other QA/QC considerations are provided in the accompanying laboratory report.

## **Cross Contamination**

Prior to entering the property, the Industrial Hygienist and his Technician donned disposable Tyvek suits.

Prior to the collection of each specific sample, a fresh pair of surgical gloves was donned to protect against the possibility of cross contamination. The pliable ruler used to measure each surface area was decontaminated with a single-use disposable alcohol wipe between samples.

## **REGULATORY CERTIFICATION**

Recently, there has been some misunderstandings regarding "certification of compliance." According to the State of Colorado Revised Statutes, Title 25, Article 18.5, Part 103:

(2) (a) Except as specified in paragraph (b) of this subsection (2), once a property owner has received certificates of compliance from a ...consultant in accordance with section 25-18.5-102(1)(e), or has demolished the property, or has met the clean-up standards and documentation requirements of this section as it existed before August 7, 2013, ....

In turn, "section 25-18.5-102(1)(e) as referenced in the above paragraph states that the State shall develop:

25-18.5-102(1)(e) (e) Procedures for contractors and consultants to issue certificates of compliance to property owners upon completion of assessment, decontamination, and sampling of illegal drug laboratories to certify that the remediation of the property meets the clean-up standards established by the board under paragraph (a) of this subsection (1).

The State developed those procedures and compiled those procedures in Regulation 6 CCR 1014-3 (Amended), wherein those regulations state that upon attainment of the requirements found in 6 CCR 1014-3, the consultant shall issue:

8.8 A certificate of compliance, signed by the Consultant, in the following form:



"I do hereby certify that I conducted clearance sampling of the subject property in accordance with 6 CCR 1014-3, Part 1, § 6. I further certify that the cleanup standards established by 6 CCR 1014-3, Part 1, § 7 have been met as evidenced by testing I conducted."

Thus, the "certificate of compliance" as described in State statutes and State regulations does not come from the State, or the Colorado Department of Public Health and Environment, or the County Health or Building Department, or the Governing Body, or any other entity but, rather, exclusively from the contractor and the consultant who affirm compliance and issue the "Certificate of Compliance."

The confusion may arise due to several misconceptions, not least of which is the Statute defining Governing Body; CRS 25-18.5-101(7):

(7) "Governing body" means the agency or office designated by the city council or board of county commissioners where the property in question is located. If there is no such designation, the governing body shall be the county, district, or municipal public health agency, building department, and law enforcement agency with jurisdiction over the property in question.

And wherein State statutes CRS 25-18.5-103(2)(a)(I) require the property owner to

Shall furnish copies of the certificates of compliance to the governing body;

That is, the Consultant issues the Certificate of Compliance, and is required to provide that Certificate of Compliance to the property owner who is, in turn, required to furnish a copy of the Certificate of Compliance to the Governing Body. This has been misconstrued by some individuals to think that the "Certificate of Compliance" comes from the Governing Body to the owner.

However, state statutes, clearly and explicitly define the authority of the Governing Body:

*25-18.5-105. Drug laboratories - governing body - authority*

(1) Governing bodies may declare an illegal drug laboratory that has not met the clean-up standards set by the board in section 25-18.5-102 a public health nuisance.

(2) Governing bodies may enact ordinances or resolutions to enforce this article, including preventing unauthorized entry into contaminated property; requiring contaminated property to meet clean-up standards before it is occupied; notifying the public of contaminated property; coordinating services and sharing information between law enforcement, building, public health, and social services agencies and officials; and charging reasonable inspection and testing fees.

There is nothing in State statutes or State regulations that otherwise provide the Governing Body with the authority to pre-empt or override or waive any portion of the regulations or the statutes. Furthermore, there is nothing in the State regulations or Statutes that give the Governing Body the authority to declare noncompliant properties as





“compliant,” and there is nothing in State statutes or State regulations that give the Governing Body the authority to over-ride an otherwise lawfully issued and valid Certificate of Compliance.

Whilst a property owner may decide that being a “good neighbor” with the Governing Body is beneficial, there is nothing in CRS 25-18-5.101 *et seq* or 6 CCR 1014-3 that requires the property owner or the Consultant to notify the Governing Body of any activities or provide the Governing Body with any documents including the Preliminary Assessment, except at the end of the project as part of the Certificate of Compliance.

It has been our experience, that most Governing Bodies are entirely unaware of the provisions found in Regulations and Statutes and essentially declare by fiat various “requirements” that simply do not exist. Recently in a discussion with one Governing Body, after making several erroneous pronouncements of “regulations” the regulator stated “*Maybe I should sit down and learn what the regulations really say.*” FACTs believes that the regulations and statutes are the standards that provide the level ground used to establish expectations when applied equitably.

## **CONCLUSIONS**

Based on the totality of circumstances, the subject property located at 262 Homestead Circle, Bayfield, CO is compliant with the regulatory requirements of 6 CCR 1014-3, and this report is the Consultant’s certification of compliance as specified in State regulations 6 CCR 1014-3 and by CRS 25-18.5-103 (2)(a).

\*END\*



# **Appendix A**

## **Supporting Documents**

**Property Description**  
**Law Enforcement Documentation**  
**Structural Features Description**  
**Room Inventory**  
**Plumbing Inspection**  
**Appliance Inventory**  
**Ventilation Inspection and Inventory**  
**Field Observations**  
**Individual Sewage Disposal System Field Form**  
**Photograph Logs**  
**Signature Sheet**  
**SOQ**

<b>FACTs project name: Homestead</b>	<b>Form # ML1</b>
<b>Date: April 24, 2015</b>	
<b>Reporting IH:</b>	<b>Caoimhín P. Connell, Forensic IH</b>

**Property Description:**

Physical address	<b>262 Homestead Circle, Bayfield 81122</b>		
Legal description or VIN	<b>Account Number R422802 Parcel Number 5677-152-01-018 Legal Summary Lot: 18, PROJ#96-049, REPLAT OF VILL EAST S/D Subdivision: THE HOMESTEAD AT BAYFIELD</b>		
Registered Property Owner	<b>Peter D Rowland P O Box 257 Durango, CO 81302</b>		
Number of structures	<b>Two</b>		
Type of Structures	Main residence	1,680	Square feet
	Detached garage	484	Square feet
	<b>Total</b>	<b>2,164</b>	<b>Square feet</b>
Adjacent and/or surrounding properties	North: Single family residence		
	South: Single family residence		
	East: Residential Street front		
	West: Open fields		
General Property Observations	<b>Excellent, well kempt, pride of ownership</b>		
Describe presumed or confirmed manufacturing method	<b>Possession, smoking</b>		

**Describe the exterior conditions:** Xeriscape with undeveloped land to the west and north

**Exterior indicators of contamination or disposal: None**

**Identify Conditions That Limit Inspection: ("X" as appropriate): None**

Heavy snow \_\_\_\_\_ Heavy vegetation \_\_\_\_\_ Trash/Debris \_\_\_\_\_ Crime scene limits \_\_\_\_\_

Fencing/Security \_\_\_\_\_ Regulatory restrictions \_\_\_\_\_ No lawful authority \_\_\_\_\_

Unsafe conditions \_\_\_\_\_ circle as appropriate:

(dogs, animals, traps, chemical, human threats, holes, structural collapse, terrain).

**Law Enforcement Documentation**

<b>FACTs project name: Homestead</b>	<b>Form # ML2</b>
<b>Date: April 24, 2015</b>	
<b>Reporting IH:</b>	<b>Caoimhin P. Connell, Forensic IH</b>

Inventory of Reviewed Documents	Interviews with: La Plata County Sheriff's Office Bayfield Marshall's Office
Described method(s) of production	No records
Chemicals identified by the LEA as being present	None
Cooking areas identified	None
Chemical storage areas identified	None
LE Observation on areas of contamination or waste disposal	None

**Inventory of Chemicals involved**

Chemical ID	Code	Chemical ID	Code	Chemical ID	Code
None	None				

P= present on scene; S= suspected; U=Unknown



**FORENSIC APPLICATIONS CONSULTING TECHNOLOGIES, INC.**

April 23, 2015

Marshal Joseph McIntyre  
Bayfield Marshals Office  
1199 Bayfield Parkway,  
Bayfield, CO 81122

Via email: [jmcintyre@bayfieldgov.org](mailto:jmcintyre@bayfieldgov.org)

Dear Marshall McIntyre:

Forensic Applications, Inc. has been contracted to perform a "Preliminary Assessment" at an identified illegal drug lab pursuant to Colorado Board Of Health Regulations 6-CCR-1014-3, and CRS §25-18.5-101 *et seq.* The property is located in the City of Bayfield, CO:

**262 Homestead Circle, Bayfield, CO 81122**

As you are probably aware, as part of that assessment, the Industrial Hygienist is required by regulation (6-CCR-1014-3 (§4.2)) to review available law enforcement documents associated with the property.

We would like to review any narratives regarding controlled substances or hazardous materials responses, or speak with any Law Enforcement personnel who may be familiar with any controlled substance issues at the property. We are only interested in issues involving controlled substances or hazardous materials responses. If no such records are available please let us know and we will merely make that notation in our report to the Governing Body.

Forensic Applications takes extreme caution to protect all Law Enforcement Sensitive information. When requested by the Law Enforcement Agency, we do NOT reveal names, document identities, or include any information considered sensitive by an investigating agency. We have developed a close working relationship with Colorado Law Enforcement Agencies and we value and respect that open line of communication. Please feel free to call me directly with any comments or questions. Please advise us of any fees associated with our request. If you need copies of our reports on this property, please let me know. We will be at the property tomorrow (Friday, April 24), and we can visit your office at that time if that is more convenient.

Pursuant to CRS §24-72-305.5, I affirm that upon receipt of requested records of official actions and/or criminal justice records from the Bayfield Marshall's Office, such records shall not be used for the direct solicitation of business for pecuniary gain.

Sincerely,

Caoimhín P. Connell  
Forensic Industrial Hygienist



**FORENSIC APPLICATIONS CONSULTING TECHNOLOGIES, INC.**

April 23, 2015

Sheriff Seán Smith  
La Plata County Sheriff's Office  
742 Turner Dr.  
Durango, CO 81303

Via: Fax: 970-247-1618

Dear Sheriff Smith:

Forensic Applications, Inc. has been contracted to perform a "Preliminary Assessment" at an identified illegal drug lab pursuant to Colorado Board Of Health Regulations 6-CCR-1014-3, and CRS §25-18.5-101 *et seq.* The property is located in the City of Bayfield, CO:

**262 Homestead Circle, Bayfield, CO 81122**

As you are probably aware, as part of that assessment, the Industrial Hygienist is required by regulation (6-CCR-1014-3 (§4.2)) to review available law enforcement documents associated with the property. We have already sent a similar request to Marshall McIntyre.

We would like to review any narratives regarding controlled substances or hazardous materials responses, or speak with any Law Enforcement personnel who may be familiar with any controlled substance issues at the property. We are only interested in issues involving controlled substances or hazardous materials responses. If no such records are available please let us know and we will merely make that notation in our report to the Governing Body.

Forensic Applications takes extreme caution to protect all Law Enforcement Sensitive information. When requested by the Law Enforcement Agency, we do NOT reveal names, document identities, or include any information considered sensitive by an investigating agency. We have developed a close working relationship with Colorado Law Enforcement Agencies and we value and respect that open line of communication. Please feel free to call me directly with any comments or questions. Please advise us of any fees associated with our request. If you need copies of our reports on this property, please let me know. We will be at the property tomorrow (Friday, April 24), and we can visit your office at that time if that is more convenient.

Pursuant to CRS §24-72-305.5, I affirm that upon receipt of requested records of official actions and/or criminal justice records from the La Plata County Sheriff's Office, such records shall not be used for the direct solicitation of business for pecuniary gain.

Sincerely,

Caoimhín P. Connell  
Forensic Industrial Hygienist

## Structural Features Description

FACTs project name: Homestead		Form # ML3
Date: April 24, 2015		
Reporting IH:	Caoimhin P. Connell, Forensic IH	

### Structural Features:

Feature	#	Code	Feature	#	Code
Apparatus room	0	NA	Kitchen	1	R
Attic	0		Laundry room	1	R
Balcony (interior)	0		Living Room	1	R
Basement	0		Lobby	0	NA
Bathrooms (full)	2	R	Office	0	
Bedrooms	3	R	Outbuilding	1	R
Carport	0	NA	Porch	0	NA
Ceiling plena	0		Portico	0	
Cellar	0		Recreation room	0	
Closets	5		R	Shower room	
Crawlspace	1	N	Sink only room	0	
Decks	0	NA	Specialty room	0	
Dining room	1	R	Stairway	0	
Exterior hall	0	NA	Storage room	0	
Foyer	1	R	Toilet Room	0	
Furnace room	1	N	Utilities room	1	
Garage	1	R	THIS SPACE IS BLANK		
Hallways	1	R			

Codes: Evidence of: Contamination= C; Cooking =M; Disposal =D; Storage = S; Use = U; R= Residual; N= No evidence

**Describe any newly painted surfaces:** South west bedroom, west and east walls. Living room, east central beam

**Description of attic penetrations:** No attic

**Description of structural floor and penetrations:** Structural floor is hidden from view with an "apron" installed by the manufacturer. Steel beam construction. Plumbing, electrical and ducting penetrations were observed. Structural floor appears to be in an uncompromised condition.

**Describe condition of crawlspace vapor barrier (if present):** No vapor barrier present

**If an attic is present? No Is it shared? No If so, how is it shared?:** NA

**If an attic is present, describe condition and use:** No attic

**Is a crawlspace is present? Yes Is it shared? No If so, how is it shared?:** NA

## Room Inventory

<b>FACTs project name: Homestead</b>	<b>Form # ML4</b>
<b>Date: April 24, 2015</b>	
<b>Reporting IH:</b>	<b>Caoimhin P. Connell, Forensic IH</b>

<b>Room #</b>	<b>Description</b>	<b>ft2</b>
1	Southeast Bedroom	<500
2	Southwest Bedroom	<500
3	Common Bathroom	<500
4	Laundry room	<500
5	Living room complex, Kitchen, hallway, foyer	810
6	Master bedroom	<500
7	Master bathroom	<500
8	Master closet (not a room)	60
9	Garage	484

THIS SPACE IS BLANK



## Plumbing Inspection and Appliance Inventory

<b>FACTs project name: Homestead</b>	<b>Form # ML5</b>
<b>Date: April 24, 2015</b>	
<b>Reporting IH:</b>	<b>Caoimhin P. Connell, Forensic IH</b>

Room #	Feature	Fixture	Comments
3	Bathroom # 1	Sink 1	Unremarkable
3	Bathroom # 1	Toilet	Unremarkable
3	Bathroom # 1	Bath/Shower	Unremarkable
7	Bathroom # 2	Sink East	Unremarkable
7	Bathroom # 2	Sink West	Unremarkable
7	Bathroom # 2	Toilet	Unremarkable
7	Bathroom # 2	Shower	Unremarkable
5	Kitchen #1	N Sink	Unremarkable
5	Kitchen #1	S Sink	Unremarkable
5	Kitchen #1	Refrigerator	Unremarkable
5	Kitchen #1	Microwave	Unremarkable
5	Kitchen #1	Stove	Unremarkable
5	Kitchen #1	Dishwasher	Unremarkable
4	Laundry room	Chest freezer	Unremarkable
4	Laundry room	Clothes washer	Unremarkable
4	Laundry room	Clothes dryer	Unremarkable

THIS SPACE IS BLANK

## Ventilation Inspection and Inventory

<b>FACTs project name: Homestead</b>	<b>Form # ML6</b>
<b>Date: April 24, 2015</b>	
<b>Reporting IH:</b>	<b>Caoimhín P. Connell, Forensic IH</b>

Item	Y/N	Comments
Isolated AHU:	Y	Unremarkable
Common air handling units:	N	
Common air intake?	N	
Common bathroom exhausts?	N	
Forced air system?	Y	Unremarkable
Steam heat?	N	
Common ducts to other properties?	N	
Passive plena to other properties?	N	
Active returns to other properties?	N	
Passive wall grilles to other properties?	N	
Industrial ventilation?	N	
Residential ventilation?	Y	Unremarkable
Pressurized structure?	N	
Item	Number	Comments
Number of bathroom exhaust fans	2	Unremarkable
Number of other exhaust fans	1	Range/stove to exterior
Number of ductless heat exchange units	0	
Number of attic fans	0	
Number of whole house fans	0	
Number of independent swamp coolers/ AC Units	0	

## Field Observations

<b>FACTs project name: Homestead</b>	<b>Form # ML7</b>
<b>Date: April 24, 2015</b>	
<b>Reporting IH:</b>	<b>Caoimhín P. Connell, Forensic IH</b>

### Structure:

Indicator		Indicator		
Acids	①	Match components	No Comment	
Aerosol cans	①	Mercury		
Alcohols (MeOH, EtOH)	①	Methamphetamine		
Ammonia	No Comment	Modified coolers/containers	1,2,3,4,5,6,8	
Ammunition		Modified electrical		
Artistic expressions		Modified plumbing		
Bags of salt		Modified structure		
Bases		Modified ventilation		
Basters/Pipettes		Needles/Syringes		
Batteries		①		OTC Containers
Bi-phasic wastes	No Comment	OTC drugs		
Booby traps		pH papers/indicators		
Bullet holes		Phenyl-2-propanone		
Burn marks		Pornography, Sex toys		
Cat litter		Prescription drugs		
Chemical storage	①	Presence of cats		
Colored wastes	No Comment	Propane bottles		
Corrosion on surfaces		Pseudoephedrine		
Death bag		Red P		
Delaminating paint		Red Staining		
Drug paraphernalia		Reserved		
Empty OTC Containers	①	Salters		No Comment
Ephedrine	No Comment	Security devices		
Feces		Signs of violence		
Filters		Smoke detectors disabled		
Reserved		Solvents - (organic)		
Funnels		Squalor		
Gang markings		Staining on floors		
Gas cylinders		Staining on walls or ceiling		
Gerry cans		Stash holes		
Glassware		Taping on surfaces		
Graffiti		Tubing		
Heating mantle/hot plate		Urine containers		
Hidden items		Wall anchors		
Hydrogen peroxide		Wall coverings		
Iodine		Wall damage		
Lead		Weapons		
Lithium		Window block material		
Marijuana		Yellow staining		

① Present but not as indicia

② Copious or unusual quantities

③ Present in normal household expectations

④ Modified in manner consistent with clanlab use

**INDIVIDUAL SEWAGE DISPOSAL SYSTEM FIELD FORM**

<b>FACTs project name: Homestead</b>	<b>Form # ML8</b>
<b>Date: April 24, 2015</b>	
<b>Reporting IH:</b>	<b>Caoimhín P. Connell, Forensic IH</b>

	Yes	No	N/C
Does the property have an ISDS		X	
Is there unusual staining around internal drains		X	
Are solvent odors present from the internal drains		X	
Is there evidence of wastes being disposed down internal drains		X	
Are solvent odors present from the external sewer drain stacks			X
Was the septic tank lid(s) accessible	City Sewer		
Was the leach field line accessible			
Was the septic tank <u>or</u> leach field lines opened			
Are solvent odors present from the leach field lines (if "yes" see below)			
Are solvent odors present from the septic tank (if "yes" see below)			
Is "slick" present in the septic tank			
Are biphasic (aqueous-organic) layers present in the septic tank			
Was pH measured in the septic tank			
Were organic vapors measured in the septic tank (if "yes" see below)			
Is sampling of the ISDS warranted			
Were calawasi/drum thief samples collected from the septic tank			

\*NC = Not checked

**Qualitative Organic Vapor Monitoring**

<b>Instrument Type</b>	<b>Make and Model</b>
Hydrocarbon detector	
pH Strips	

<b>Location</b>	<b>MOS</b>	<b>PID*</b>	<b>FID*</b>
		NA	
<b>All surrounding soils (see body of report for explanation)</b>			

\*Units of measurement are in parts per million equivalents compared to the toluene calibration vapor. Detection limit 1 ppm

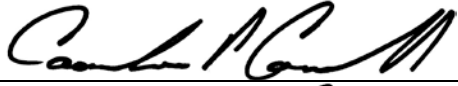

**Locator Notes:**

No location required for this property

**CERTIFICATION, VARIATIONS AND SIGNATURE SHEET**

<b>FACTs project name: Homestead</b>	<b>Form # ML14</b>
<b>Date: May 11, 2015</b>	
<b>Reporting IH:</b>	<b>Caoimhín P. Connell, Forensic IH</b>

Certification

Statement	Signature
I hereby certify that I conducted a preliminary assessment of the subject property in accordance with 6 CCR 1014-3, Part 1, § 4.	
I do hereby certify that the analytical results reported here are faithfully reproduced.	

In the section below, describe any variations from the standard:

No variations occurred.

**Pursuant to the language required in 6 CCR 1014-3, § 8.8**

I do hereby certify that I conducted clearance sampling of the subject property in accordance with 6 CCR 1014-3, Part 1, § 6. I further certify that the cleanup standards established by 6 CCR 1014-3, Part 1, § 7 have been met as evidenced by testing I conducted.

Signature 

Date: May 11, 2015





## Forensic Applications Consulting Technologies, Inc. Consultant Statement of Qualifications

FACTs project name:	Homestead	Form # ML15
May 11, 2015		

Caoimhín P. Connell, has been involved in clandestine drug lab investigations since 2002 and meets the Colorado Revised Statute §24-30-1402 definition of an "Industrial Hygienist" and is authorized under 6 CCR 1014-3 to perform assessments in illegal drug laboratories. He has been a practicing Industrial Hygienist since 1987. Mr. Connell is a recognized authority in drug-lab operations and is a Certified Instructor in Meth-Lab Safety through the Colorado Regional Community Policing Institute, CRCPI (Colorado Division of Criminal Justice) and was the lead instructor for the CRCPI providing over 260 hours of methlab training for over 45 Colorado Law Enforcement Agencies, federal agents, probation and parole officers throughout Colorado judicial districts. He has provided meth-lab lectures to the US Air Force, the National Safety Council, and the American Industrial Hygiene Association (of which he is a member and serves on the Clandestine Drug Lab Work Group and for whom he conducted the May, 2010, Clandestine Drug Lab Course, and is a coauthor of the AIHA methlab assessment publication.)

Mr. Connell is a member of the American Conference of Governmental Industrial Hygienists, the Occupational Hygiene Society of Ireland, the Colorado Drug Investigators Association, an appointed Member of the National Fire Protection Association, and the ASTM International Forensic Sciences Committee, (where he was the sole sponsor of the draft ASTM E50 *Standard for the Assessment of Suspected Clandestine Drug Laboratories*).

From 2009, Mr. Connell served as the Industrial Hygiene Subject Matter Expert on the Federally funded Interagency Board (Health, Medical, and Responder Safety SubGroup), and was elected full member of the IAB-HMRS in 2011 where he now serves. He is the only private consulting Industrial Hygienist in Colorado certified by the Office of National Drug Control Policy High Intensity Drug Trafficking Area Clandestine Drug Lab Safety Program, and P.O.S.T. certified by the Colorado Department of Law.

He has received over 194 hours of highly specialized law-enforcement sensitive training in drug lab operation, and under supervision of the US DEA, he has manufactured methamphetamine using a variety of street methods. He has received highly specialized drug lab assessment training through the Iowa National Guard, Midwest Counterdrug Training Center and the Florida National Guard Multijurisdictional Counterdrug Task Force, St. Petersburg College, Rocky Mountain HIDTA, as well as through the US NHTSA, and the U.S. Bureau of Justice Assistance (US Dept. of Justice) and he is currently ARIDE Certified.

Mr. Connell is a current sworn law enforcement officer who has conducted clandestine laboratory investigations and performed risk, contamination, hazard and exposure assessments from both the law enforcement (criminal) perspective, and from the civil perspective in residences, apartments, motor vehicles, and condominiums. Mr. Connell has conducted over 586 assessments of illegal drug labs in CO, SD, NE, OK, and collected over 5,293 samples during assessments (a partial detailed list of drug lab experience is available on the web at): <http://forensic-applications.com/meth/DrugLabExperience2.pdf>

He has extensive experience performing assessments pursuant to the Colorado meth-lab regulation, 6 CCR 1014-3, and was an original team member on two of the legislative working-groups which wrote the original regulations for the State of Colorado and he was the primary contributing author of Appendix A (*Sampling Methods And Procedures*) and Attachment to Appendix A (*Sampling Methods and Procedures Sampling Theory*) of the original Colorado regulations. Mr. Connell strongly objected to the unscientific, unfounded and inappropriate amendments now applicable to those original regulations.

Recommended by the US NIOSH as Peer Review Expert for the NIOSH 9109 Method, *Methamphetamine*, he has been admitted as a drug lab expert in Colorado, and an Industrial Hygiene Expert in Colorado in both civil and criminal courts as well as Federal Court in Pennsylvania. He has provided expert testimony in several criminal cases including Grand Jury testimony and testimony for US Bureau ATF and he testified before the Colorado Board of Health and Colorado Legislature Judicial Committee regarding methlab issues. Mr. Connell has provided services to private consumers, Indian Nations, State Investigators, and Federal Investigators.



# Multijurisdictional Counterdrug Task Force Training

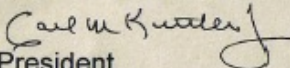


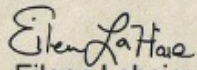
This is to certify that  
**Caoimhin P. Connell**

Has satisfactorily completed the following 24 hour MCTFT training course held at  
**DIVIDE, CO**

**Rural Patrol**

Training held 9/27/2004 through 9/29/2004

  
President  
St. Petersburg College

  
Eileen Lahaie  
MCTFT Director

A partnership between The Florida National Guard and St. Petersburg College

Midwest Counterdrug Training Center



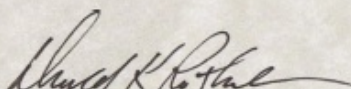
# Certificate of Training

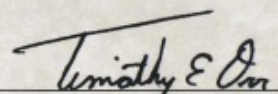
This certifies that

**Caoimhin Connell**

Has successfully completed the  
**Clandestine Laboratory Certification**

Cheyenne, WY  
40 Training Hours  
2-6 August 2004

  
Network Environmental Systems, Inc.

  
LTC Timothy E. Orr  
Commandant



# Center *for* Task Force Training™

THIS IS TO CERTIFY THAT

*Caoimhin P. Connell*

HAS SUCCESSFULLY COMPLETED 20 HOURS OF TRAINING IN

**METHAMPHETAMINE INVESTIGATION MANAGEMENT**

MARCH 20-22, 2006

DENVER, COLORADO

Domingo S. Herraiz  
Director, Bureau of Justice Assistance

Training coordinated by the  
Institute for Intergovernmental  
Research® on behalf of BJA



## State and Local Anti-Terrorism Training

THIS IS TO CERTIFY THAT

**Caoimhin P. Connell**

HAS SUCCESSFULLY COMPLETED AN 8-HOUR  
STATE AND LOCAL ANTI-TERRORISM TRAINING PROGRAM  
NARCOTICS TASK FORCE ANTI-TERRORISM BRIEFING

**June 1, 2006**

**Denver, Colorado**

Domingo S. Herraiz  
Director, Bureau of Justice Assistance



Training coordinated on behalf of BJA  
by the Institute for Intergovernmental Research



*Rocky Mountain  
High Intensity Drug Trafficking  
Area*



*Certifies that*



*Caoimhín Connell*

*has attended*

*4 hours of*

*Hash Oil Extraction: The Scene and The Patient*

*Aurora, CO*

*July 25, 2014*

*Training Manager, Rocky Mountain HIDTA*

*Director, Rocky Mountain HIDTA*



[www.nesglobal.net](http://www.nesglobal.net)

*Certificate of Completion*

*Caoimhin Connell*

*has successfully completed training in*

*Advanced Clan Labs: Beyond the Basics*

*presented by*

*NES, Inc.*

*1141 Sibley Street Folsom, CA 95630*

*Instructor - Brian Escamilla*

*04/28/14 04/30/14*

*Date*

*Contact Hours:24*

This certifies that

*Caoimhin P Connell*

Has met the requirements for the online course

*Expert Testimony Training for the Prosecutor and Scientist*



11-07-2012

Certificate Number: 1109778763

For more information please visit <http://www.rti.org/forensiced>



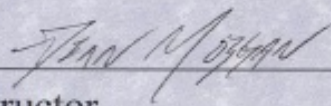
## Park County Sheriff's Office Certificate of Completion

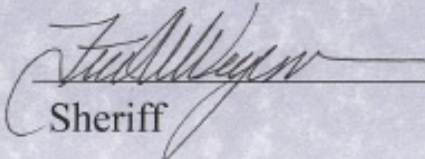
# Caoimhin Connell

has completed an 8 hour course in:

### Crime-scene Approach and Evidence Collection

Completed this 29th day of April, 2009

  
Instructor

  
Sheriff

***Rocky Mountain  
High Intensity Drug Trafficking  
Area***



*Certifies that*



**Caoimhín P. Connell**

*has attended  
2 hours of  
Hash Oil Explosions  
Woodland Park, CO  
May 31, 2014*

Training Manager, Rocky Mountain HIDTA

Director, Rocky Mountain HIDTA

***Certificate of Completion***

*This Will Certify That*

***Caoimhín P. Connell***

*Successfully Completed*

**Prescription Drug Crimes**

7 Hours Completed

At: CO Law Enforcement Officers Assn. On: September 30, 2010  
Greeley, Colorado



**P. Ritch Wagner**  
Instructor

Director, Law Enforcement Liaison & Education



# Certificate of Training

This is to certify that  
Caoimhin Connell

(Name)

Park County Sheriff's Office

(Agency)

If the bearer of this document possesses a 40 Hour certificate pursuant to 29 CFR §1910.120, this certifies the above named has met the refresher training requirements of 29 CFR §1910.120(e)(8) and is hereby **RECERTIFIED** in Clandestine Laboratory Safety / HazWoper

Sponsored by  
Rocky Mountain High Intensity Drug Trafficking Area  
Colorado Regional Community Policing Institute

Caoimhin P. Connell 4/12/10  
Caoimhin P. Connell, Instructor/Date  
Glean HARDEY



## Colorado Law Enforcement Officers' Association



This is to certify that

**CAOIMHIN CONNELL**

Completed **ARIDE (Advanced Roadside Impaired Driving Enforcement)**

hosted by **Loveland Police Department**

on **February 28 – March 1, 2011**

Tom Finelle  
Tom Finelle, CLEOA President

M. A. [Signature]  
ARIDE Instructor

# State of Colorado



THE BOARD ON PEACE OFFICER STANDARDS AND TRAINING  
HEREBY AWARDS THIS CERTIFICATE  
AS INSPECTOR OF VEHICLE IDENTIFICATION NUMBERS  
TO

**CAOIMHIN PADRAIG CONNELL**

**August 27, 2008**

Date

VIN INSP— **0952**

Number

*For fulfilling the prescribed requirements as an Inspector of Vehicle Identification Numbers and as a peace officer in Colorado, pursuant to Title 42, Article 5, Section 206 Colorado Revised Statutes.*

*Bill Ritter Jr.*

Governor

*John W. Suthers*

Attorney General, Board Chairperson

## Certificate of Completion Intoxilyzer 9000 Operator Certification Course

*The Evidential Breath Alcohol Testing Program of the  
Colorado Department of Public Health and Environment certifies that*

**Caoimhin P Connell**

User ID: **841645**

*has successfully completed the "Intoxilyzer 9000 Operator Certification Course"  
to determine the alcohol concentration in breath specimens pursuant to the  
State Board of Health Rules Pertaining to Testing for Alcohol and Other Drugs (5 CCR, 1005-2)  
Training was provided by the Evidential Breath Alcohol Testing Program  
of the Colorado Department of Public Health and Environment.*

**February 21, 2013**

Certificate Date

*Jeffrey A. Groff*

Jeffrey A. Groff, Program Manager  
Evidential Breath Alcohol Testing Program



*David A. Butcher*

David A. Butcher, Director  
Laboratory Services Division  
Colorado Department of Public Health  
and Environment

Certification expires 180 days from certificate date. Recertification must be per 5 CCR 1005-2.



# Certificate of Achievement

awarded to:

**Caoimhin P. Connell**

Has successfully completed Methamphetamine Lab Cleanup Management and Supervision training in accordance with 29 CFR 1910.120 and State Regulations Pertaining to the Cleanup of Methamphetamine Laboratories (8Hrs.)

June 1st, 2005

Date

Signed

HAZMAT Plans & Programs, Inc. 30 S. Havana St. Suite 304F Aurora, Colorado 80012 (303) 360-9801  
"Safety Plans, Programs and Training Tailored To The Needs Of Your Business"

## CERTIFICATE OF COMPLETION

COLORADO LAW ENFORCEMENT ASSOCIATIONS TRAINING PROJECT

*This Certifies That*

**Caoimhin Connell**

Has Attended the

**CLEAT 40-HOUR**

**Train the Trainer Course**

Hosted by Breckenridge Police Department  
August 14-18, 2006

Karen M. Renshaw, CAE  
Executive Director  
Colorado Association of Chiefs of Police



John L. Kammerzell  
Executive Director  
Police Officer Standard & Training



Donald E. Christensen  
Executive Director  
County Sheriffs of Colorado





**SINCE 1973**

*This is to certify that*

**Caoimlin P. Connell**

*Has completed a 24 hour training program in Vehicle Identification Number  
Inspection*

*Presented this 24th day of May, 2008*

CATI President

VIN Inspector Training Coordinator

**State of Colorado**



THE BOARD ON PEACE OFFICER STANDARDS AND TRAINING  
AWARDS THIS CERTIFICATE  
TO

**CAOIMHIN PADRAIG CONNELL**

**May 6, 2004**

Date

B- 10670

Number

*For fulfilling the prescribed requirements for certification. This certificate expires three years from date of  
issuance unless the certificate holder meets the requirements for continued certification as established by law  
and the P.O.S.T. Board.*

Governor

Attorney General, Board Chairperson

*Rocky Mountain  
High Intensity Drug Trafficking  
Area*



*Certifies that*



***Caoimhín Connell***

*has attended*

*16 hours of*

***MCTC / RMHIDTA Indoor Marijuana Grows***

*Centennial, CO*

*August 28-29, 2014*

*Training Manager, Rocky Mountain HIDTA*

*Director, Rocky Mountain HIDTA*

**CERTIFICATE OF TRAINING**

THIS IS TO CERTIFY THAT

***Caoimhín Connell***

**Has completed 4 hours of successful training for**

**The Hazards of Hash Oil Extraction**

**Held at IRIS Fire Investigations in Englewood, CO**

**on this 7<sup>th</sup> day of November, 2014**

**Robert K. Toth  
IRIS Fire Investigations, President**





**COLORADO**  
Department of Public  
Health & Environment

Dedicated to protecting and improving the health and environment of the people of Colorado

December 30, 2014

Caoimhin Connell  
Forensic Applications Consulting Technologies Inc  
185 Bounty Hunter Ln  
Bailey, CO 80421

**Consultant Interim Authorization Approval**

Dear Caoimhin Connell:

The Hazardous Materials and Waste Management Division of the Colorado Department of Public Health and Environment (the Department) has reviewed the application for Consultant Interim Authorization and has determined the application to be complete and in compliance with 6 CCR 1014-3, Regulations Pertaining to the Cleanup of Methamphetamine-Affected Properties (the Regulations).

The Department approves the application for **Consultant Interim Authorization**. This interim authorization approval shall expire on June 15, 2015.

Assessment and sampling of methamphetamine-affected properties may only be conducted by Consultant Firms that have received interim authorization under Part 2, Section 3.2.4 of the Regulations. Therefore, this interim authorization may only be used to conduct assessment and sampling of methamphetamine-affected properties for a Consultant Firm that has received interim authorization approval from the Department.

Approved By: \_\_\_\_\_

Date: \_\_\_\_\_

12/30/2014





**COLORADO**  
Department of Public  
Health & Environment

Dedicated to protecting and improving the health and environment of the people of Colorado

December 30, 2014

Forensic Applications Consulting Technologies Inc  
185 Bounty Hunters Ln  
Bailey, CO80421

**Consultant Firm Interim Authorization Approval**

Dear Forensic Applications Consulting Technologies Inc:

The Hazardous Materials and Waste Management Division of the Colorado Department of Public Health and Environment (the Department) has reviewed the application for Consultant Firm Interim Authorization and has determined the application to be complete and in compliance with 6 CCR 1014-3, Regulations Pertaining to the Cleanup of Methamphetamine-Affected Properties (the Regulations).

The Department approves the application for **Consultant Firm Interim Authorization**. The firm shall only utilize individuals who have received interim authorization under Part 2, Section 3.2.1 of the Regulations to conduct assessment and sampling of methamphetamine-affected properties. This interim authorization approval shall expire on June 15, 2015.

The Regulations require submittal of electronic copies of reports to the Department. Electronic copies of reports should be submitted via email to [cdphe\\_methlabdocuments@state.co.us](mailto:cdphe_methlabdocuments@state.co.us). The words "report" or "report submittal" should be included in the email subject line, and the property address should be included in the body of the email.

Alternatively, compact disks with electronic copies of reports may be mailed to:

Colorado Department of Public Health and Environment  
Hazardous Material and Waste Management Division  
4300 Cherry Creek Drive South  
Denver, CO 80246-1530  
Attn: Colleen Brisnehan or Richard Mruz

Packages may also be hand delivered to the Department's mail room located in the northwest corner of Building B (700 South Ash Street).

Approved By: \_\_\_\_\_

Date: 12/30/2014



**Appendix B**  
**Analytical Reports**  
**Field Sampling Sheets**

**SAMPLING FIELD FORM**

<b>FACTS project name:</b> Homestead	<b>Form #</b> ML 17
<b>Date:</b> April 24, 2015	<b>Alcohol Lot#:</b> NA <b>Gauze Lot#:</b> NA
<b>Reporting IH:</b> Caoimhin P. Connell, Forensic IH	<b>Preliminary</b> <b>Clearance</b> <b>Post</b>

Sample ID	Type	Location	Time	Dimensions	Substrate
HM042415-01	W	FOURNA & Gemossite	18:32	10x10x1	Wool
-02	W	SE BRM / Closet DR	18:36	10x10x1	Wool
-03	W	SUD BRM / Closet DR FRAME	18:40	14.28x7x4	Wool
-04	W	Common Bath / EXHAUST FAN COVER	18:03	10x10x4	W
-05	W	LAUNDRY / TOP OF CABINET	18:36	10x10	PM
-06	W	WASHER / INSIDE DOOR	18:35	10x10	PM
-07	W	Dryer / INSIDE DOOR	18:39	10x10	PM
-08	W	FREEZER / Lip	18:49	10x10	PM
-09	W	KITCHEN TOP OF CABINET	19:18	10x10x4	W
-10	W	KLR Complex / TOP OF light FIXTURE (LR)	19:18	10x10	G
-11	W	BOX	19:56	<del>10x10</del>	PI
-12	W	FRIDGE / shelf	19:05	<del>10x10</del>	PI
-13	W	Kitchenware / INSIDE DOOR	19:07	10x10	GI
-14	W	DISH WASHER / INSIDE DOOR	19:10	10x10	GI
-15	W	STOVE / INSIDE DOOR	19:12	10x10	PMG

Sample Types: W=Wipe; V=Microvacuum; A=Air; B=Bulk; L=Liquid  
 Surfaces: DW=Drywall, P=Painted; W=Wood, L=Laminated, V=Varnished, M=Metal, C=Ceramic, PI=Plastic

DF = CALCULATION TRK INSD ACCOUNT SLATS OF EXHAUST COVER

NOTE - Samples OBSERVED

RUSH 159 Suite

**SAMPLING FIELD FORM**

<b>FACTs project name:</b> Homestead	<b>Form #</b> ML 17
<b>Date:</b> April 24, 2015	<b>Alcohol Lot#:</b> NA <b>Gauze Lot#:</b> NA
<b>Reporting IH:</b> Caoimhin P. Connell, Forensic IH	<b>Preliminary Clearance Post</b>

Sample ID	Type	Location	Time	Dimensions	Substrate
HM042415-16	W	MASSE BROW <del>TOP</del> BE FRAME INTO BAT H (LIQUID) (510)	19:34	18.18 x 5.5	V LUD
-17	W	MSTE BAY TOP LIGHT FIXTURE	19:39	10 x 12 x 4	G
-18	W	GARAGE / GARAGE DOOR RAIL	19:49	2.5 x 4.0	M
-19	W	GARAGE DOOR STEEL BEAM	19:50	6 x 6.7 x 4	DM
-20	W		19:57		
-21	W				
-22	W				
-23	W				
-24	W				
-25	W				
-26	W				
-27	W				
-28	W				
-29	W				
-30	W				

Sample Types: W=Wipe; V=Microvacuum; A=Air; B=Bulk; L=liquid  
 Surfaces: DW=Drywall, P=Painted; W=Wood, L=Laminated, V=Varnished, M=Metal, C=Ceramic, PI=Plastic

CRACK SPACE: NO VAPOR BARRIER - STEEL BEAM BEAM FLOORING - HO LEAK - NO EVIDENCE OF DUMPING

**REGULATORY COMPOSITE LOG FORM**

<b>FACTS project name: Homestead</b>		<b>Form: Composites</b>	
<b>Date: April 24, 2015</b>		<b>Alcohol Lot#: Gauze Lot#:</b>	
<b>Reporting IH: Caoimhin P. Connell, Forensic IH</b>		<b>Preliminary Clearance Post</b>	

Sample ID HM042415-	Type	Location	Time	Dimensions	Substrate
1	A	RETURN - COLD AIR	16:18		M
	B	Ht Exchange	16:15		
	C	Supply	16:15		
	D	RETURN Garage Room Floor Vent	16:18		





## **Forensic Applications**

### **Final Report**

**RES 318587-1,2**

**May 5, 2015**

	Page
Cover Sheet	1
Letter	2
Report / Data	3
Quality Control Data	4
Chain of Custody	5



May 5, 2015

**Laboratory Code:** RES  
**Subcontract Number:** NA  
**Laboratory Report:** RES 318587-1,2  
**Project # / P.O. #:** Homestead  
**Project Description:** 262 Homestead Circle,  
Bayfield CO 81122

Caoimhin Connell  
Forensic Applications  
185 Bounty Hunter Ln.  
Bailey CO 80421

Dear Customer,

Reservoirs Environmental, Inc. is an analytical laboratory accredited for the analysis of Environmental matrices by the National Environmental Laboratory Accreditation Program, Lab Certification #E871030. The laboratory is currently proficient in the in-house ERA PAT Program.

Reservoirs has analyzed the following sample(s) using Gas Chromatography Mass Spectrometry (GC/MS) / Gas Chromatography Flame Ionization Detector (GC/FID) per your request. The analysis has been completed in general accordance with the appropriate methodology as stated in the analysis table. Results have been sent to your office.

**RES 318587-1** is the job number assigned to this study. This report is considered highly confidential and the sole property of the customer. Reservoirs Environmental, Inc. will not discuss any part of this study with personnel other than those authorized by the client. The results described in this report only apply to the samples analyzed. This report shall not be reproduced except in full, without written approval from Reservoirs Environmental, Inc. Samples will be disposed of after sixty days unless longer storage is requested. If you should have any questions about this report, please feel free to call me at 303-964-1986.

Sincerely,

A handwritten signature in blue ink, appearing to read "Jeanne Spencer", is written over a light blue horizontal line.

Jeanne Spencer  
President



## RESERVOIRS ENVIRONMENTAL, INC.

NVLAP Accredited Laboratory #101896  
AIHA Certificate of Accreditation #480 LAB ID 101533

**TABLE I. ANALYSIS: METHAMPHETAMINE BY WIPE**

RES Job Number: **RES 318587-1,2**  
 Client: **Forensic Applications**  
 Client Project Number / P.O.: **Homestead**  
 Client Project Description: **262 Homestead Circle, Bayfield CO 81122**  
 Date Samples Received: **April 27, 2015**  
 Analysis Type: **Methamphetamine by GCMS**  
 Turnaround: **5 Day**  
 Date Samples Analyzed: **4/28/2015 - 5/4/2015**

Client ID Number	Lab ID Number	Reporting Limit (µg)	METHAMPHETAMINE CONCENTRATION (µg)
HM042515-01	EM 1393722	0.05	BRL
HM042515-02	EM 1393723	0.05	0.05
HM042515-03	EM 1393724	0.05	0.07
HM042515-04	EM 1393725	0.05	0.45
HM042515-05	EM 1393726	0.05	0.60
HM042515-06	EM 1393727	0.05	BRL
HM042515-07	EM 1393728	0.05	BRL
HM042515-08	EM 1393729	0.05	0.05
HM042515-09	EM 1393730	0.05	0.81
HM042515-10	EM 1393731	0.05	0.06
HM042515-11	EM 1393732	0.05	BRL
HM042515-12	EM 1393733	0.05	BRL
HM042515-13	EM 1393734	0.05	BRL
HM042515-14	EM 1393735	0.05	BRL
HM042515-15	EM 1393736	0.05	BRL
HM042515-16	EM 1393737	0.05	0.12
HM042515-17	EM 1393738	0.05	BRL
HM042515-18	EM 1393739	0.05	0.09
HM042515-19	EM 1393740	0.05	BRL
HM042515-20	EM 1393741	0.05	BRL

\* Unless otherwise noted all quality control samples performed within specifications established by the laboratory.

  
 Analyst / Data QA: Michael Schlaumloeffel

# RESERVOIRS ENVIRONMENTAL, INC.

NVLAP Accredited Laboratory #101896  
AIHA Certificate of Accreditation #480 LAB ID 101533

## QUALITY CONTROL: METHAMPHETAMINE BY WIPE


RES Job Number: **RES 318587-1,2**  
Client: **Forensic Applications**  
Client Project Number / P.O.: **Homestead**  
Client Project Description: **262 Homestead Circle, Bayfield CO 81122**  
Date Samples Received: **April 27, 2015**  
Analysis Type: **Methamphetamine by GCMS**  
Turnaround: **5 Day**  
Date Samples Analyzed: **4/28/2015 & 5/4/2015**

Quality Control Batch	Reporting Limit ( $\mu\text{g}/100\text{cm}^2$ )	Matrix Blank ( $\mu\text{g}/100\text{cm}^2$ )	Matrix Duplicate (% RPD)	Matrix Spike (% Recovery)	Laboratory Control Sample (% Recovery)
1	0.05	BRL	2	107	107
2	0.05	BRL	3	93	95

Quality Control Batch 1 = EM 1393722, 730, 732

Quality Control Batch 2 = EM 1393723-729, 731, 736-741.

\* Unless otherwise noted all quality control samples performed within specifications established by the laboratory.

Analyst / Data QA:   
Michael Schlaumloeffel

Due Date: 4/28/15  
 Due Time: \_\_\_\_\_

RES 318587

# REILAB Reservoirs Environmental, Inc.

After Hours Call Phone: 720-339-9228

## CONTACT INFORMATION:

Company:	Forensic Applications, Inc	Contact:	Caoimhin P. Connell-Sampler
Address:	185 Bounty Hunters Lane Bailey, CO 80421	Phone:	303-903-7494
Project Number and/or P.O. #:	Homestead	Fax:	
Project Description/Location:	262 Homestead Circle, Bayfield, CO 81122	Cell/pager:	
		Final Data Deliverable Email Address:	admin@forensic-applications.com

## INVOICE TO: (IF DIFFERENT)

Company: \_\_\_\_\_  
 Address: Paid w/c  
for samples

**ASBESTOS LABORATORY HOURS: Weekdays: 7am - 7pm**  
 PLM / PCM / TEM \_\_\_\_\_ RUSH (Same Day) \_\_\_\_\_ PRIORITY (Next Day) \_\_\_\_\_ STANDARD  
 (Rush PCM = 2hr, TEM = 6hr.)

**CHEMISTRY LABORATORY HOURS: Weekdays: 8am - 5pm**  
 Metal(s) / Dust \_\_\_\_\_ RUSH \_\_\_\_\_ 24 hr. \_\_\_\_\_ 3-5 Day  
 RCRA 8 / Metals & Welding \_\_\_\_\_ RUSH \_\_\_\_\_ 5 day \_\_\_\_\_ 10 day  
 Fume Scan / TCLP \_\_\_\_\_ 24 hr. \_\_\_\_\_ 3 day \_\_\_\_\_ X \_\_\_\_\_ 5 Day

**MICROBIOLOGY LABORATORY HOURS: Weekdays: 9am - 6pm**  
 E.coli O157:H7, Coliforms, S.aureus \_\_\_\_\_ 24 hr. \_\_\_\_\_ 2 Day \_\_\_\_\_ 3-5 Day  
 Salmonella, Listeria, E.coli, APC, Y & M \_\_\_\_\_ 48 Hr. \_\_\_\_\_ 3-5 Day  
 Mold \_\_\_\_\_ RUSH \_\_\_\_\_ 24 Hr \_\_\_\_\_ 48 Hr \_\_\_\_\_ 3 Day \_\_\_\_\_ 5 Day

\*\*Prior notification is required for RUSH turnarounds.\*\*

\*\*Turnaround times establish a laboratory priority, subject to laboratory volume and are not guaranteed. Additional fees apply for afterhours, weekends and holidays.\*\*

Standard REI Reporting Limits Please report all samples as total µg Please use entire sample.

Client sample ID number	(Sample ID's must be unique)
1	HM042515-01
2	HM042515-02
3	HM042515-03
4	HM042515-04
5	HM042515-05
6	HM042515-06
7	HM042515-07
8	HM042515-08
9	HM042515-09
10	HM042515-10

Sample Area (cm2)	Matrix Code	# Containers	Date Collected mm/dd/yy	Time Collected hh:mm a/p	REQUESTED ANALYSIS		VALID MATRIX CODES		LAB NOTES:
					ARCHIVE ONLY - Do Not Analyze	ORGANICS - METH	Air = A	Bulk = B	
400	W	1	04/25/15	14:18	X	X			
400	W	1	04/25/15	18:32	X	X			
400	W	1	04/25/15	18:36	X	X			
400	W	1	04/25/15	18:40	X	X			
400	W	1	04/25/15	18:03	X	X			
100	W	1	04/25/15	18:26	X	X			
100	W	1	04/25/15	18:25	X	X			
100	W	1	04/25/15	18:29	X	X			
400	W	1	04/25/15	18:53	X	X			
100	W	1	04/25/15	19:18	X	X			

Number of samples received: 20 (Additional samples shall be listed on attached long form.)  
 Sample matrix is IPA and poly-cotton gauze. Sampling performed by Caoimhin P. Connell. No preservatives

Relinquished By:		Date/Time:	4/27/15 12:25
Laboratory Use Only		Date/Time:	4/27/15 12:25
Carrier:	<u>Hand</u>		
Phone Email Fax	Phone Email Fax	Phone Email Fax	Phone Email Fax
Contact	Contact	Contact	Contact
Initials	Initials	Initials	Initials
Time	Time	Time	Time
Date	Date	Date	Date
Sealed	On Ice	Temp. (F°)	Sample Condition:
Yes / No	Yes / No		Intact
Yes / No	Yes / No		Yes / No

Due Date: 4-28-15  
 Due Time: \_\_\_\_\_

# REILAB Reservoirs Environmental, Inc.

318587  
 Page \_\_\_\_\_ of \_\_\_\_\_

After Hours Cell Phone: 720-339-9228

INVOICE TO: (IF DIFFERENT)

CONTACT INFORMATION:

<b>Company:</b> Forensic Applications, Inc <b>Address:</b> 185 Bounty Hunters Lane Bailey, CO 80421  <b>Project Number and/or P.O. #:</b> Homestead <b>Project Description/Location:</b> 262 Homestead Circle, Bayfield, CO 81122	<b>Contact:</b> Caoimhin P. Connell-Sampler <b>Phone:</b> 303-903-7494 <b>Fax:</b> _____ <b>Cell/pager:</b> _____  <b>Final Data Deliverable Email Address:</b> admin@forensic-applications.com
--	--

Client sample ID number (Sample ID's must be unique)	REQUESTED ANALYSIS		VALID MATRIX CODES		LAB NOTES:
	ARCHIVE ONLY - Do Not Analyze	ORGANICS - METH	MICROBIOLOGY	Number of aliquots	
1 HM042515-11	X	X		4	EM Number (Laboratory Use Only) 1393332
2 HM042515-12	X	X		1	3
3 HM042515-13	X	X		1	4
4 HM042515-14	X	X		1	5
5 HM042515-15	X	X		4	6
6 HM042515-16	X	X		4	7
7 HM042515-17	X	X		4	8
8 HM042515-18	X	X		4	9
9 HM042515-19	X	X		4	4030em
10 HM042515-20	X	X		4	1

Number of samples received: \_\_\_\_\_ (Additional samples shall be listed on attached long form.)

Sample matrix is IPA and poly-cotton gauze. Sampling performed by Caoimhin P. Connell. No preservatives

Relinquished By: _____	Date/Time: 4/27/15 12:25
Laboratory Use Only	Carrier: Hand
Received By: _____	Date/Time: 4/27/15 12:25

Results	Contact	Phone Email Fax	Date	Time	Initials
	Contact	Phone Email Fax	Date	Time	Initials

# **Appendic C**

## **Compact Digital Disc**

**Photographs**  
**Methods**  
**Regulations**